



product information

model 1730 - CAESAR

model 1730

design by kurt beier



GOOD DESIGN COMBINED WITH BEST SITTING COMFORT AND BEST WORKING ARE THE ESSENTIAL CHARACTERISTICS OF THIS MODEL. FURTHERMORE THE FLAPABLE ARM-AND BACKRESTS OFFER VARIOUS POSITIONS ON THE SOFA AND EVEN ENABLE THE TRANSFORMATION INTO A BED I

Modern upholstery technology, the guarantee for best quality.

Steelframe for highest stability.

Excellent sitting provided by the use of nosag steel springs as suspension.

Highend polyfoam for longlasting convenience.

Moveable arm- and backrests offer various positions even recumbency.

Soft upholstery all around by use of high quality fleece.

The comfortable chair or loveseat turns into a divan bed by flaping down the armrest.

Chair and loveseat are available with pending - function.

The types 100,150,155 and 185 are even available with high backrest (model 1740).



model 1730

design by kurt beier

quality in detail!

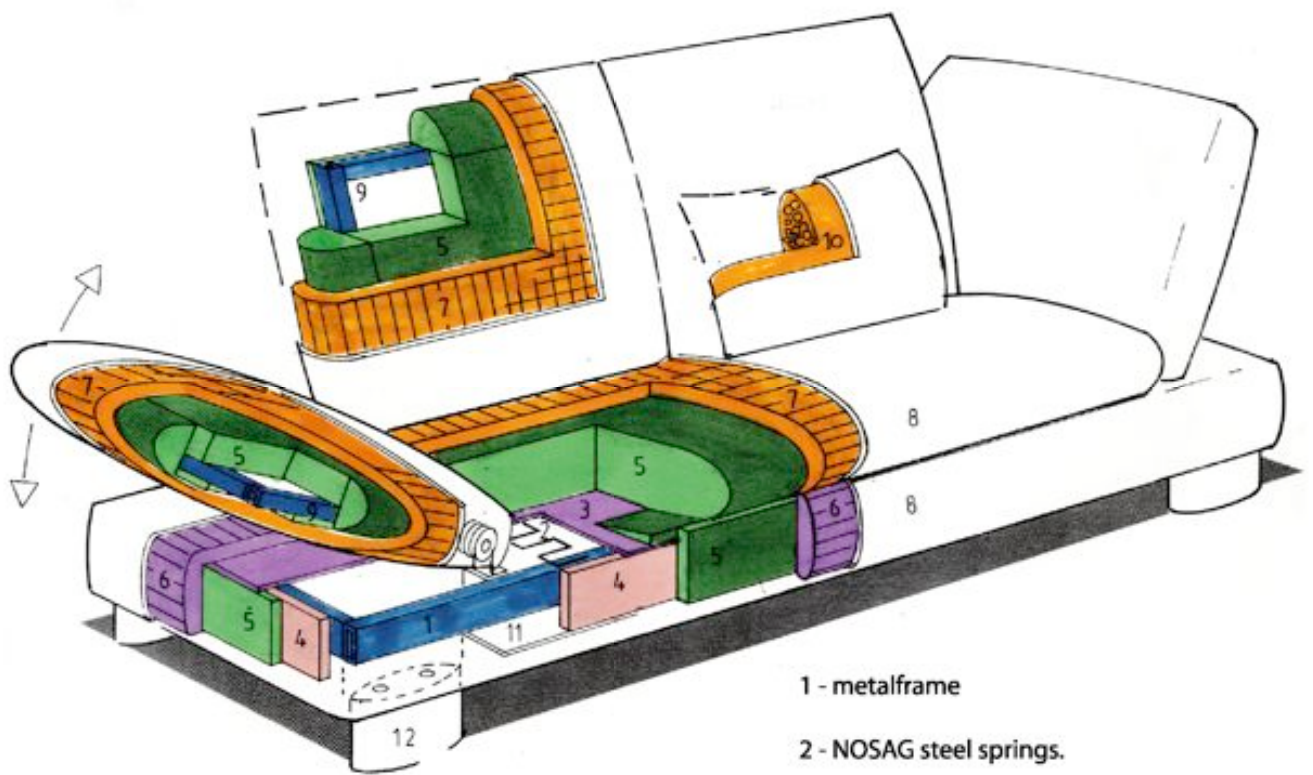

1 - metalframe

2 - NOSAG steel springs.

3 - spring covering made of Polyvlies.

4 - all around plywoodframe.

5 - polyfoam.

6 - 200 g/m² fleece sewed to the cover.

7 - 300 g/m² fleece sewed to the cover.

8 - cover.

9 - adjustable metalframe with function part.

10 - cushions filled with 100% dacron fiber.

11 - typar for bottom closing.

12 - aluminium foot.

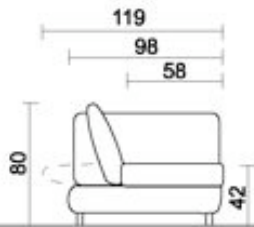

floor distance: ca. 11 cm

model 1730

design by kurt beier

(with low back)

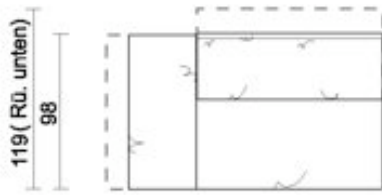

163
183 (AT. unten)

element big armrest left flex.
152

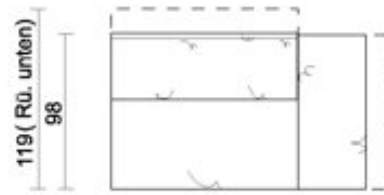

163
183 (AT. unten)

element big armrest right flex.
151



footstool
540

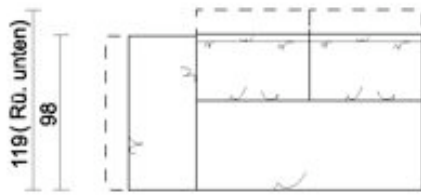

189
210 (AT. unten)

2-seater armrest left flex.
220

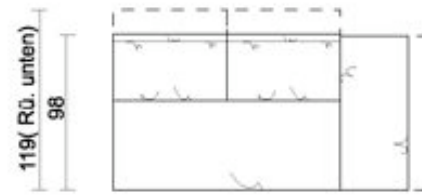

189
210 (AT. unten)

2-seater armrest right flex.
210



footstool
550



222
260 (AT. unten)

2,5-seater
240



195
233 (AT. unten)

2-seater
200



footstool
555



133
171 (AT. unten)

chair
100



133
171 (AT. unten)

pending-chair
155

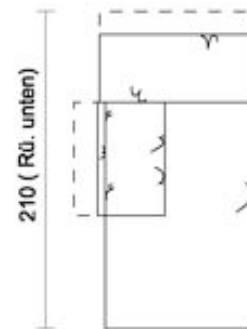

119 (AT. unten)
98

recamiere left
420

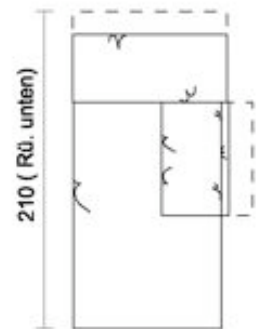

119 (AT. unten)
98

recamiere right
410



164
202 (AT. unten)

loveseat
150



164
202 (AT. unten)

pending loveseat
185



pillow
55 x 30 cm
514

model 1730

design by kurt beier

Instruction manual

How to screw on the feet

1. Screw the 2 headless pins (B) on the sofa (3 to 4 turns).
2. Push foot (A) on the headless pins, adjust it and fasten it with the sleeve nut (C).
3. Push in the plastic buttons (E).
4. Screw on the height adjustable feet (D) and position it to the level of the floor.

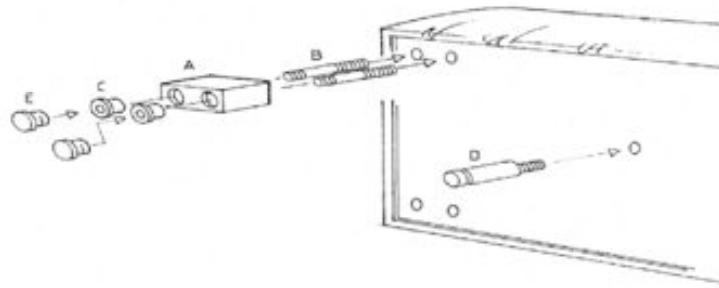

How to use the flexible arm- and backrest:

Grip the moveable rests always in their middle and pull them upwards (8 clicks).

To remove: Pull the rest to the maximum point and lay it back down to the minimum point till you hear the click.



ATTENTION!!!

Do not sit on the arm/backrest unless it is in flat position, otherwise it will seriously damage the mechanism!

